

### Replacing the Thermocouple on an X Range Nozzle

If the BX or MX nozzle is in a rear-loading configuration, you must dismantle the hot runner system to service the nozzle and then re-assemble the system. You must remove the SX nozzle from the mould. If the MX nozzle is in a Hot Half, you only need to remove the cavity plate to access nozzle tip to replace the thermocouple.

Follow these steps to replace a thermocouple from an X Range nozzle:

**ONE**

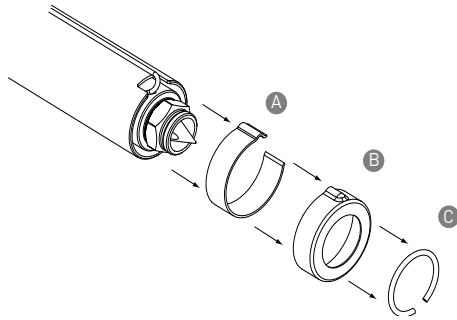

Remove the **snap ring** **C** then remove the **heater cap** **B** and lastly remove the **T/C clip** **A**

**TWO**

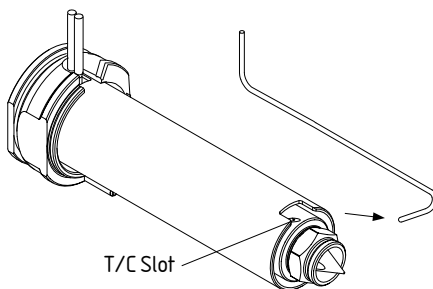

Gently remove the **T/C** from the thermocouple hole in the **nozzle head**.

**THREE**

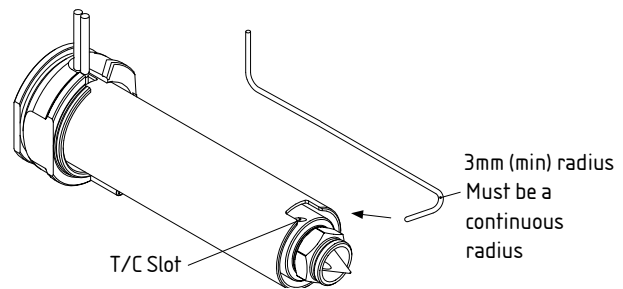

Insert the the new **T/C** into the **T/C slot** and bend it over the **Heater** as shown. Thread the **T/C wires** through the **wire channels**.

**THREE**

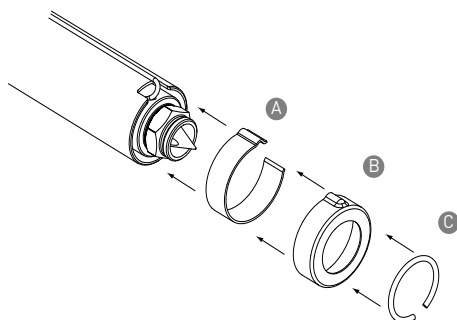

First slip on the **T/C clip** **A** then insert the **heater cap** **B** onto the heater, taking care to align the groove in the cap with the thermocouple. Lastly re-install the **snap ring** **C**.

Press the **snap ring** down firmly to ensure it is seated correctly.